

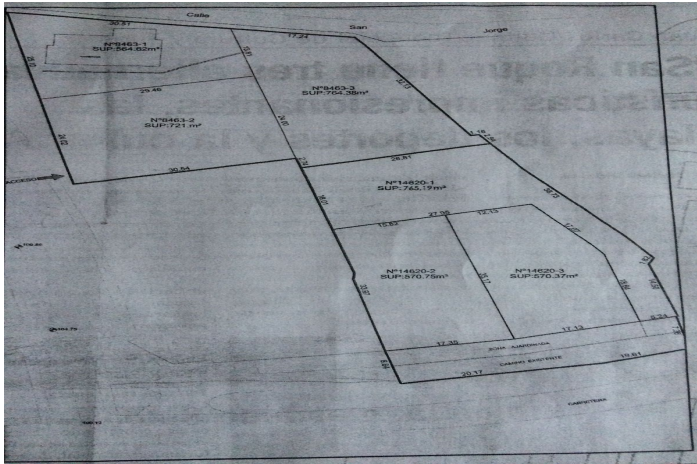

Residential Plot for sale in San Roque, San Roque

720.000 €

Reference: R4821094 Plot Size: 4.270m² Build Size: 200m²



Costa de la Luz, San Roque

MAGNIFICENT OPPORTUNITY FOR INVESTORS – Build 6 Independent Villas in the Village of Guadiaro. In the charming enclave of Guadiaro, San Roque, this exceptional urban plot presents a unique opportunity in one of the most sought-after corners of the Costa del Sol. Boasting a privileged location, this property offers unbeatable access to the most attractive spots in the area. Just minutes from Sotogrande and with essential shops and services close by, this plot is ideally situated only 4 km from the region's stunning beaches. Spanning 4,270 m², this plot is surrounded by lush gardens with mature trees that provide shade and privacy, creating an atmosphere of absolute tranquility. Breathtaking views of the countryside, the sea, and the picturesque village further enhance its appeal. Its south-facing orientation ensures abundant natural light throughout the day, making it a perfect retreat for those seeking peace and serenity. The true value of this property lies in its development potential. The plot is subdividable, allowing for the construction of up to six 200 m² villas. The land features various elevations, ensuring that each home can enjoy unobstructed views without interference from the others. Additionally, the property currently includes a 200 m² villa ready for renovation, boasting spectacular sea views—offering a rare opportunity to create a custom home or a high-end real estate project. With all essential utilities already installed, including electricity, water, and internet, this property guarantees immediate comfort and connectivity. Furthermore, its proximity to restaurants, shops, golf courses, and schools makes this an outstanding investment opportunity in one of the region's most desirable areas.



Features:

Caratteristiche

Terrazza coperta
Vicino ai mezzi di trasporto
Terrazza privata
Wifi
Vicino alla chiesa
Fibra ottica

Orientamento

Sud
Sud -ovest

Viste

Mare
Montagna
Panoramica
Campagna
Giardino
Golf
Porto
Città
Foresta
Strada
Piscina
Spazio per la piscina

Collocamento

Vicino al golf
Vicino al porto
Vicino al mare
Vicino ai negozi
Vicino alla città
Vicino alle scuole
Villaggio
Vicino alla foresta
Vicino al porto

Condizione

Eccellente

Giardino

Privato

Sicurezza

Complesso residenziale privato

Parcheggio

Privato
Più di uno

Utility

Elettricità
Acqua potabile
Telefono

Categoria

Investimento
Rivendita
Con licenza di opera approvata